



**FLOWBIRD**

Urban  
Intelligence





# CWT S4 STEALTH TOUCH

Ticket Outlet Replacement

# TOOLS NEEDED FOR TICKET OUTLET REPLACEMENT

Tools needed to complete the CWT Stealth ticket outlet replacement

- **7mm Nut Driver**



This new Ticket Outlet is compatible with the CWT S2, S3, S4 doors with GeBe Printers installed.

Part number: 24DC175; PRINTER, TICKET OUTLET UP/LOW,CWT S4

# TICKET OUTLET REPLACEMENT

Remove the four 4mm flanged nuts on the back of the ticket outlet.

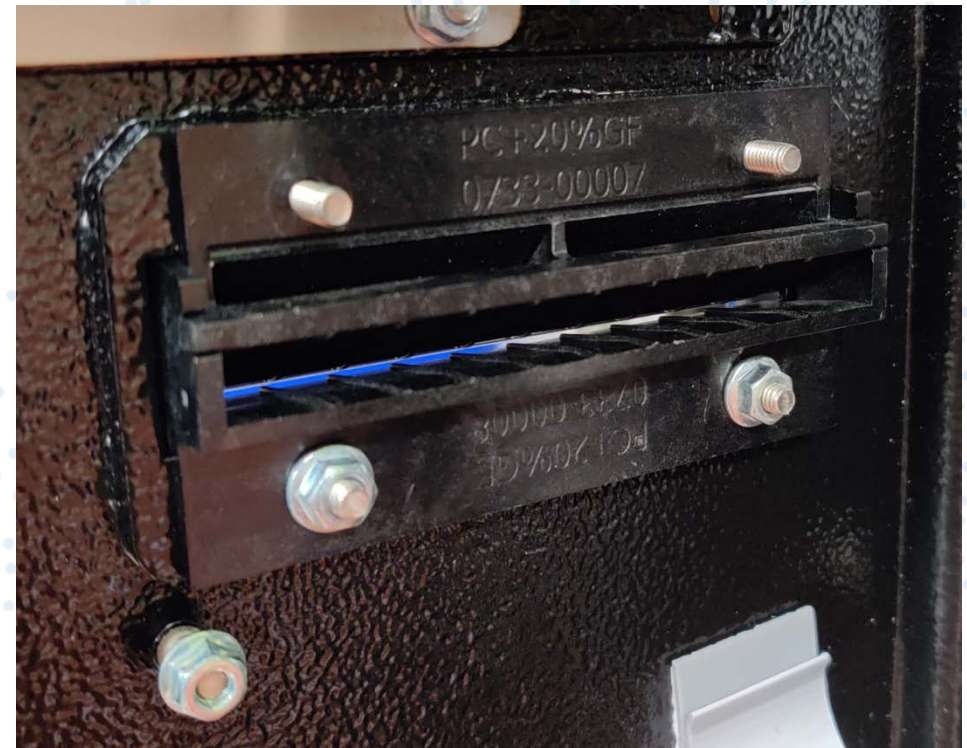
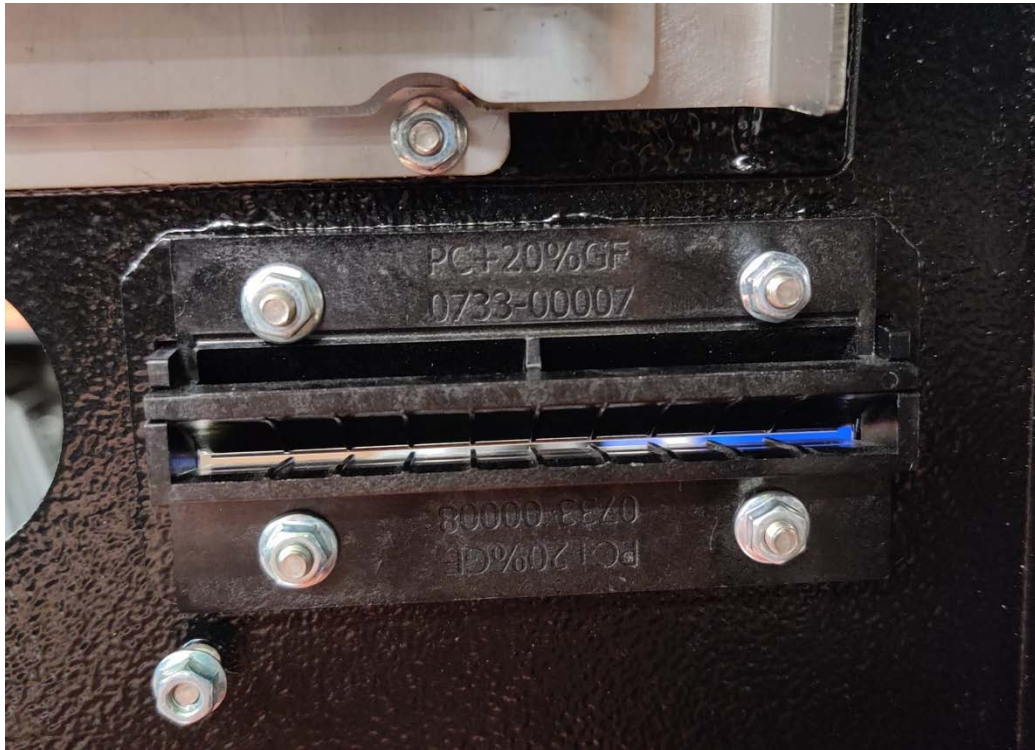

# TICKET OUTLET REPLACEMENT

Remove the four 4mm flanged nuts on the back of the ticket outlet. cont

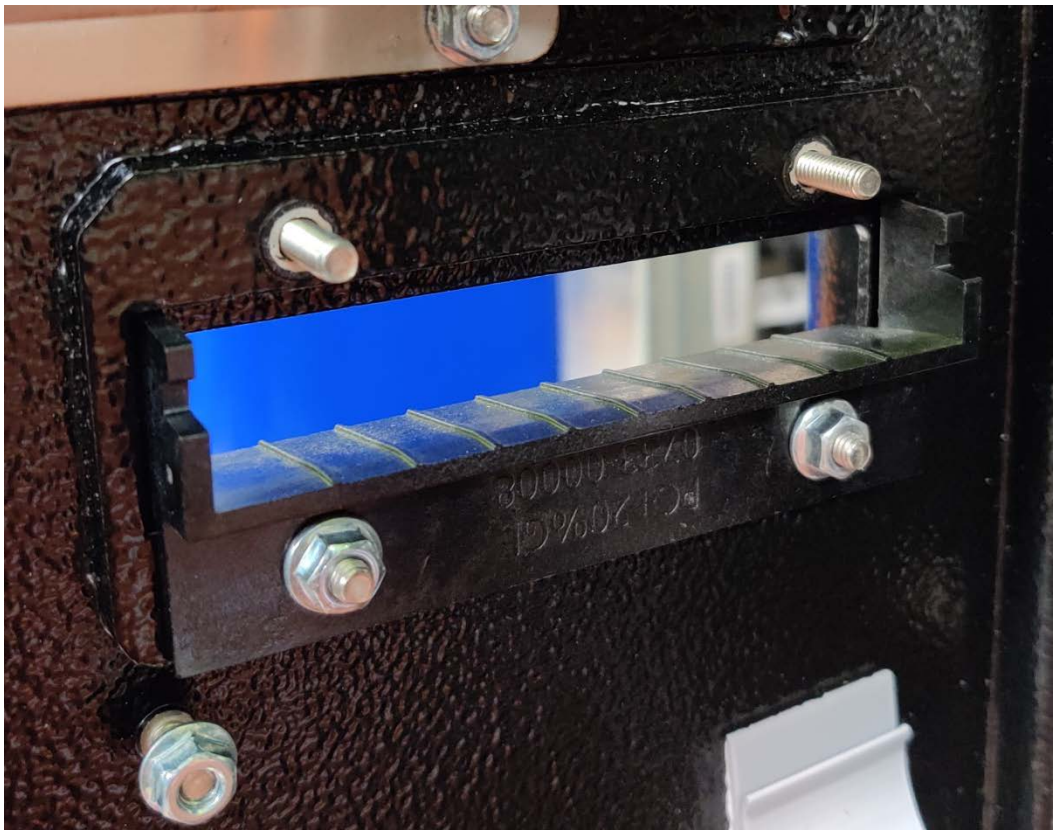

# TICKET OUTLET REPLACEMENT

Install the Top/ Front of the new ticket outlet first with two 4mm flanged nuts



# TICKET OUTLET REPLACEMENT

Hold the Top/ Front of the new ticket outlet up while installing the flanged nuts.

This is to make sure it is in the up most position.



# TICKET OUTLET REPLACEMENT

When installing the lower / back portion of the ticket outlet will need to be installed with the supplied guide bushings.

These bushings allow for the back portion to travel freely & align with the printer outlet.  
*(5mm of vertical axis travel)*

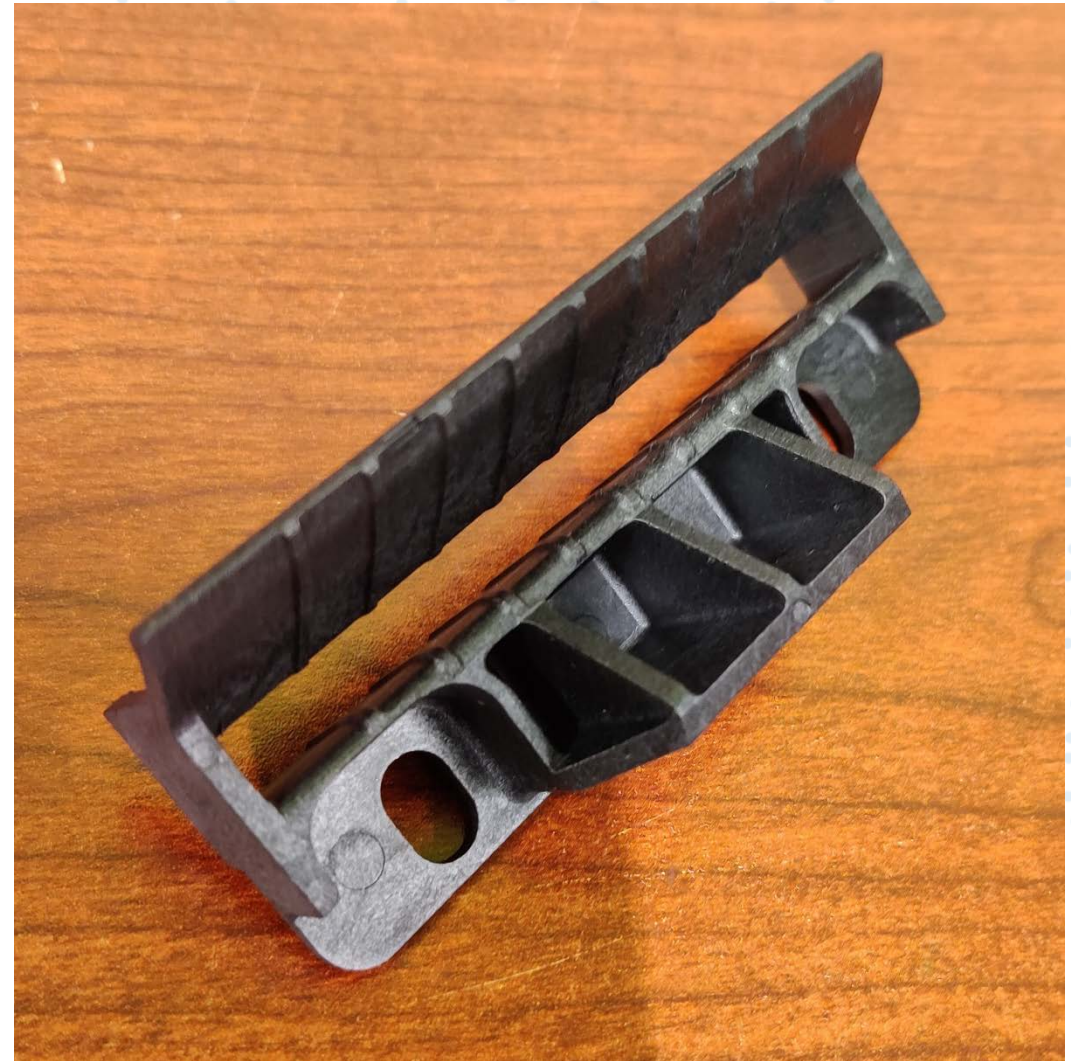



# TICKET OUTLET REPLACEMENT

Installing the lower / back portion of the ticket outlet first.

Then insert the supplied guide bushings on the studs before the flanged nuts.



# TICKET OUTLET REPLACEMENT

Install the two 4mm flanged nuts on the lower two studs



# TICKET OUTLET REPLACEMENT

Now check to make to the lower back part is moving freely and not binding.

